

# LOCKER CONTAINER

Home (<https://module-t.com/>) / Locker Container



Our sandwich panel **locker containers** are specially designed for the needs and comfort of staff. Thanks to their galvanized *steel* structures, our strong locker portable containers can withstand extreme weather conditions. Our standard **locker containers** are 6m x 2.5m / 6m x 5.00m and 260cm high. Sanitary installation (WC and shower) can be integrated into our **portable**.

- **Structure:** Locker container with high galvanized and painted steel sandwich panel surface and frame.

- **Walls:** Standard insulated with 50mm-thick-stone wool (optional: walls are of polyurethane or polystyrene foam insulation) construction site locker with sandwich panel. Polyurethane (50mm) ceiling insulation.
- **Quick-mount container:** Cloakroom container with quick-mount sandwich panel: the modular cloakroom can be installed or removed in a matter of hours. All sandwich panels are cut and painted at the factory. The lower and upper chassis are pre-assembled at the factory.
- **Portable locker container:** prefabricated locker container can be transported with lifting hooks (optional: specially reinforced locker container type for frequent construction site transports).
- 
- **Set delivery of cloakroom containers:** The cloakroom container is dismantled and delivered in sets to minimize transport costs.
- **Optional interior arrangement:** Locker and sanitary cabins (WC, urinal, sink and shower) can be added. You can combine your sanitary bungalows with other prefabricated modules to create larger structures for the living spaces of your construction site.
- **Optional materials:** Metal cloakroom cupboard with single shelf 185cmx50cmx40cm, with two shelves 185cmx80cmx40cm, with three shelves 185cmx117cmx40cm , with four shelves 200cmx80x40cm, steel frame benches in lengths ranging from 60 cm to 200 cm .
- Locker containers are mounted on a lightweight construction structure: concrete block or beam.
- 



(<https://module-t.com/wp-content/uploads/2019/12/locker1-1.jpg>)



(<https://module-t.com/wp-content/uploads/2019/12/locker2-1.jpg>)

### **Locker container: examples of configuration**

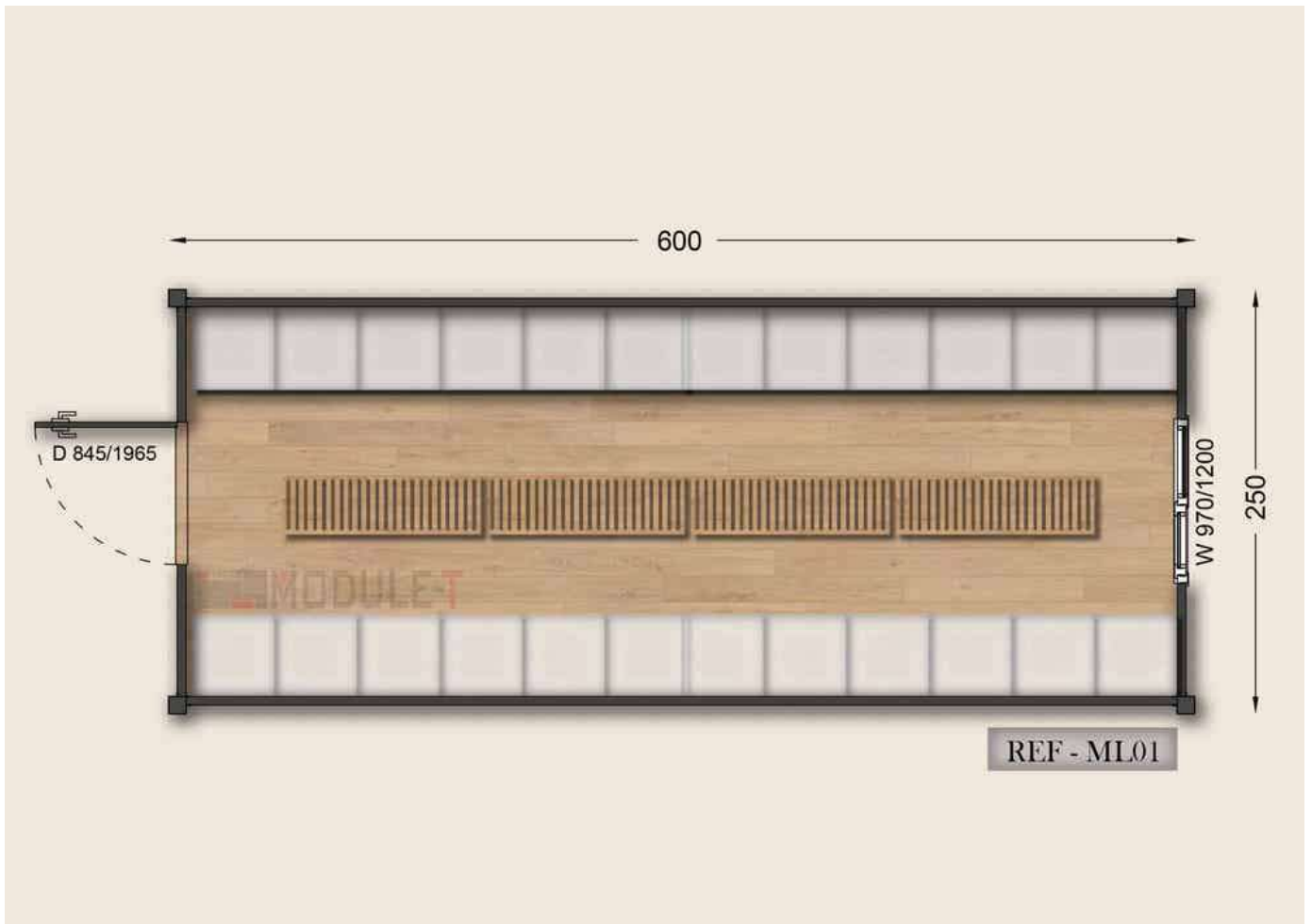

(<https://module-t.com/wp-content/uploads/2019/12/locker-configuration1.jpg>)

### Simple locker container 20"

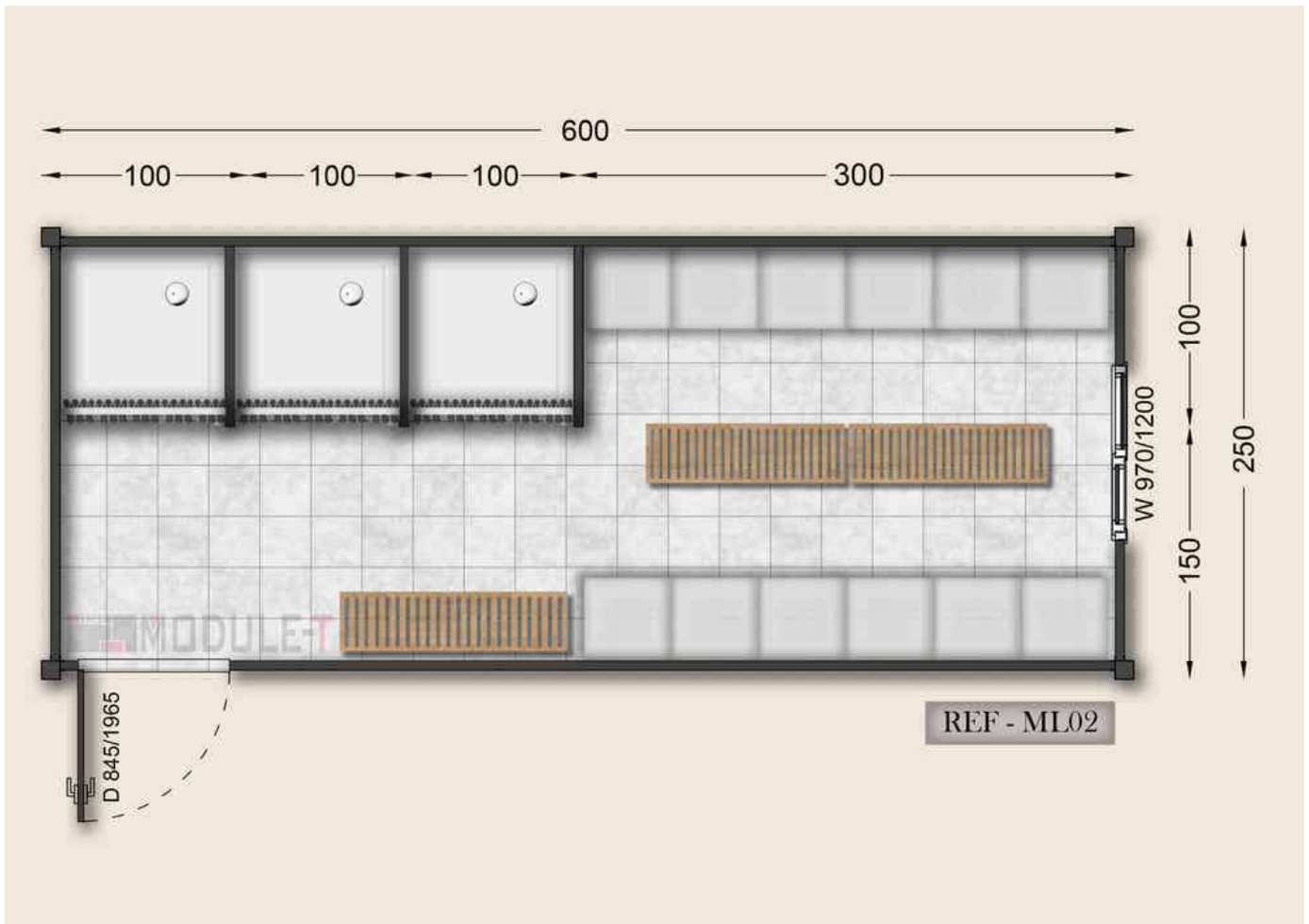

(<https://module-t.com/wp-content/uploads/2019/12/locker-configuration2.jpg>)

### Locker container with shower 20"



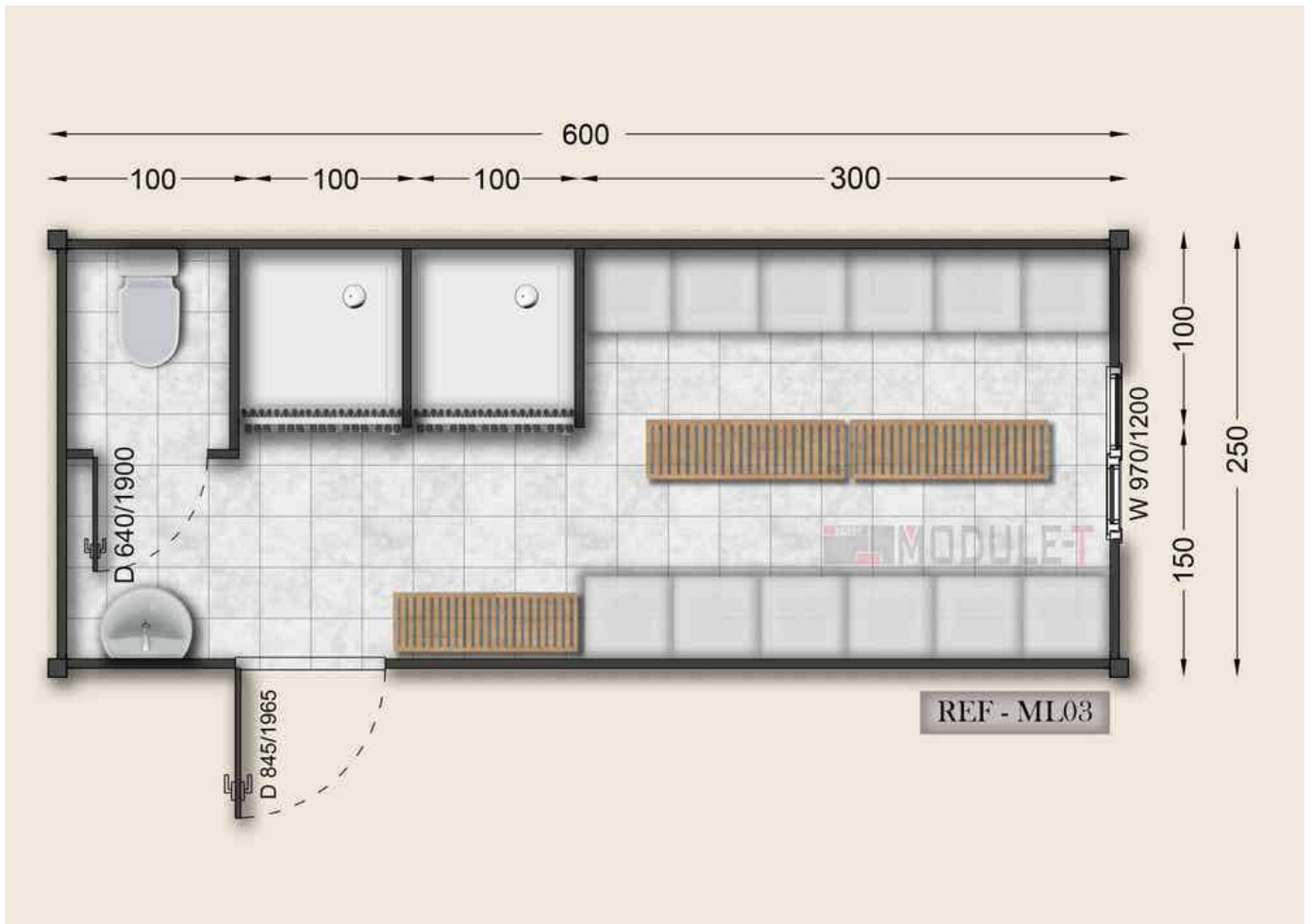

(<https://module-t.com/wp-content/uploads/2019/12/locker-configuration3.jpg>)

### Locker container with WC & shower 20"

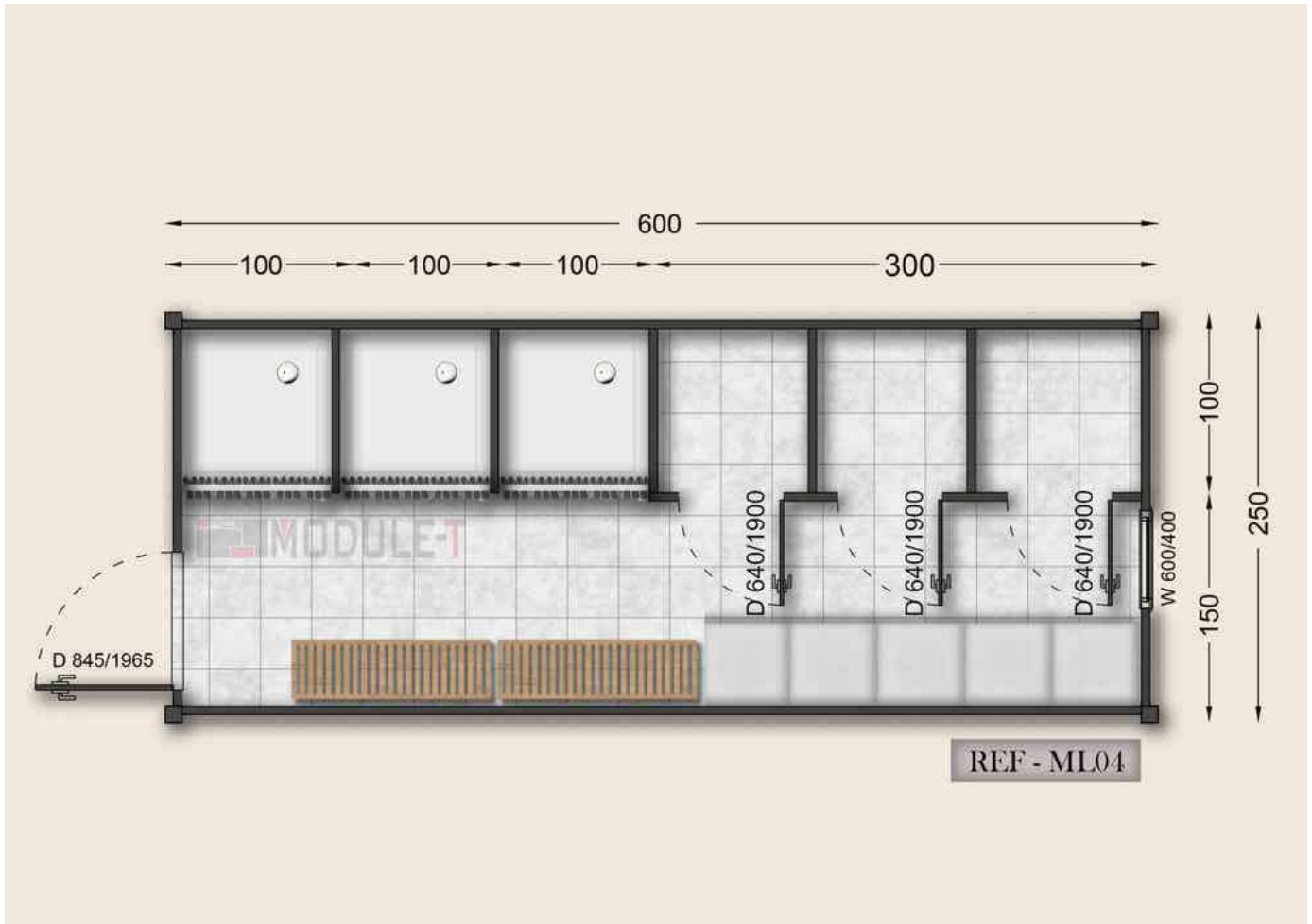

(<https://module-t.com/wp-content/uploads/2019/12/locker-configuration4.jpg>)

### Locker container shower 20"

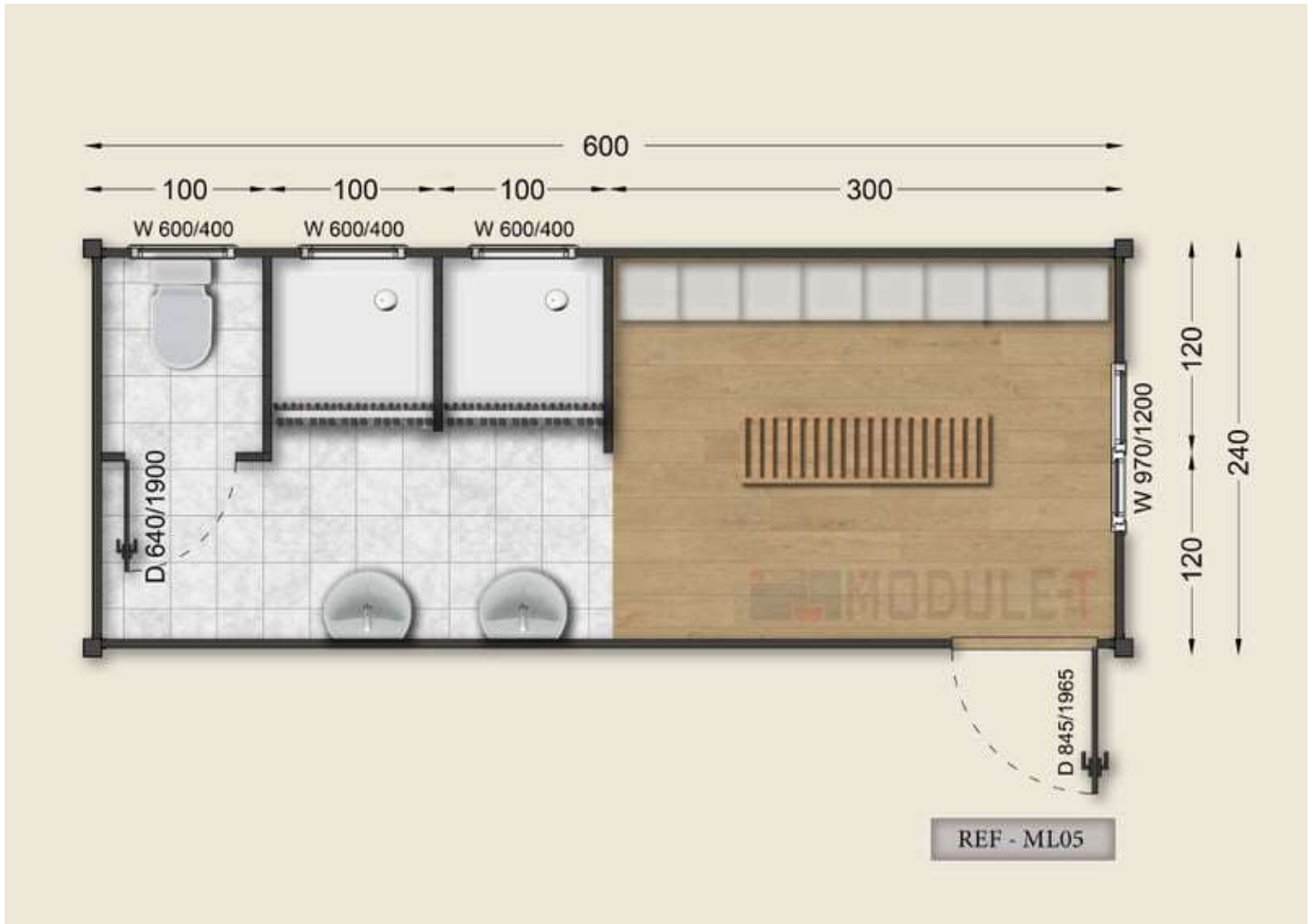

(<https://module-t.com/wp-content/uploads/2020/12/ML-05-3.jpg>)

### Locker prefabricated Container 20 feet





(<https://module-t.com/wp-content/uploads/2019/12/locker-configuration6.jpg>)

### Locker container shower 40"



(<https://module-t.com/wp-content/uploads/2019/12/locker-configuration7.jpg>)

### Locker container WC & shower 40"

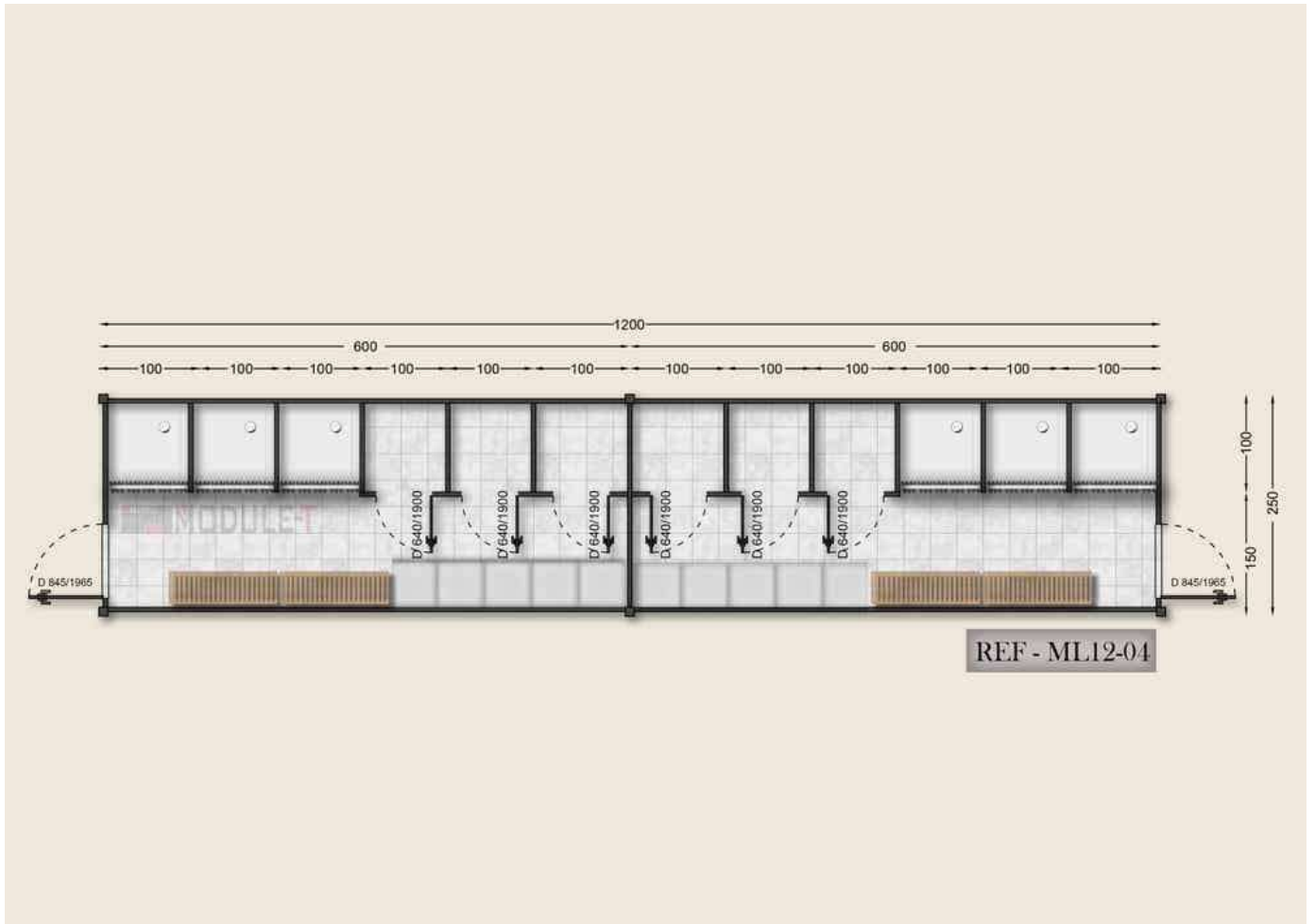

(<https://module-t.com/wp-content/uploads/2019/12/locker-configuration8.jpg>)

Locker container 40" with cabin

3D Modular Container Design (/3d/)

CONTACT US

MODULE T PREFABRIK SISTEMLERİ

📍 SOGANLIK YENI MAH. BALTACI MEHMET PASA SK. AC MOMENT ISTANBUL 4/B 221 KARTAL ISTANBUL TURKEY

☎ +90 216 337 0540